



# VRX 25 AND 25-S WINCH

Getting into a premium winch is now easier than ever

The VRX™ 25 and VRX 25-S pack loads of features into a premium package without the premium pricing. Perfect for smaller ATVs that work and play hard, the VRX 25 features all-metal IP68 waterproof construction, an all-metal gear train, a new clutch design based on WARN 4WD hub lock know-how, and a host of high-performance features without the high price.

- VRX 25 Includes 50' x 3/16" steel rope, roller fairlead and zinc-plated hook
- VRX 25-S Includes 50' of lightweight, easy-to-handle 3/16" synthetic rope, hawse fairlead and zinc-plated hook
- Robust 2,500 lb. capacity is perfect for ATVs
- Load-holding mechanical brake for great control
- Durable all-metal construction
- New clutch design based on legendary WARN 4WD hub lock know-how
- Complete IP68 waterproof sealing keeps all the elements out
- Semi-gloss back powder-coated finish and stainless steel fasteners for corrosion resistance
- Smooth and reliable all-metal three-stage planetary gear train
- Handlebar-mounted rocker switch
- Limited lifetime warranty (mechanical), 3 year warranty (electrical)



VRX 25, PN 101025    VRX 25-S, PN 101020

# WARN® VRX™ POWERSPORTS WINCHES

PREMIUM FEATURES WITHOUT THE PREMIUM PRICE

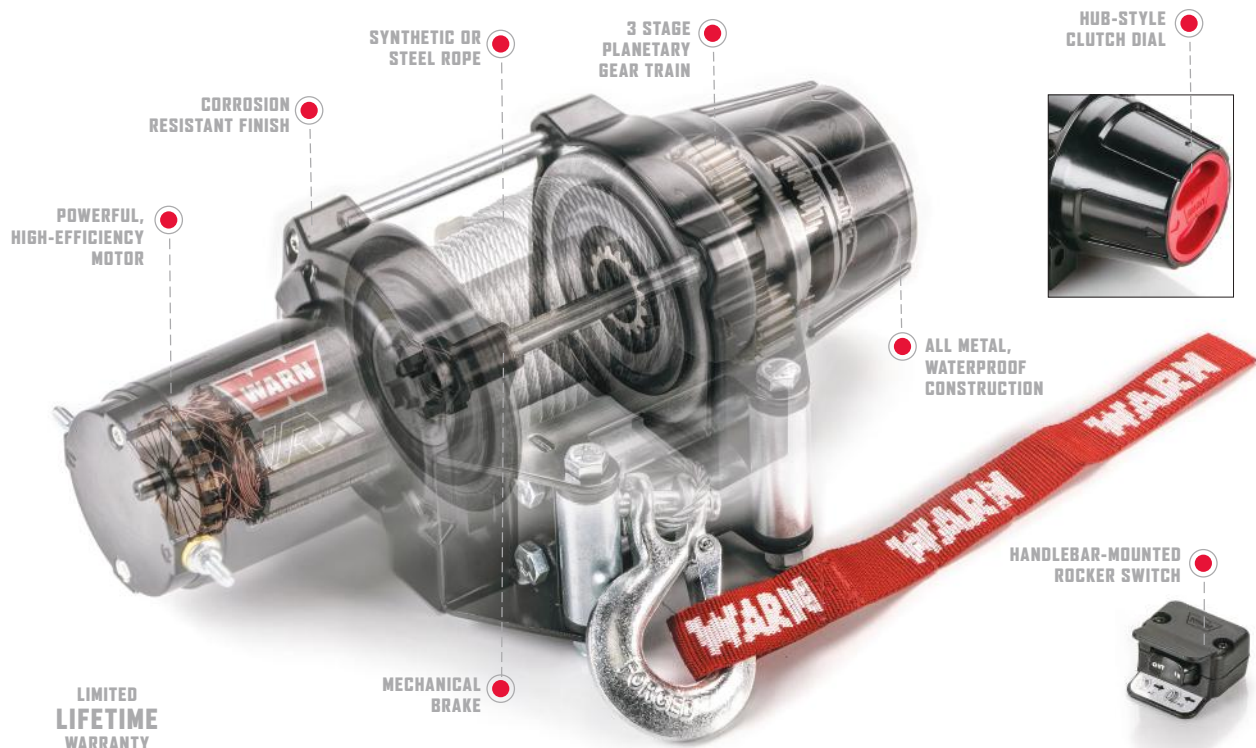

## SPECIFICATIONS

**Winch model:** VRX 25 or VRX 25-S

**Part numbers:** 101025 (VRX 25), 101020 (VRX 25-S)

**Rated line pull:** 2500 Lbs. (1134 kg) single-line

**Motor:** 12V DC permanent magnet

**Sealing:** IP68 waterproof

**Geartrain:** 3-stage planetary

**Fasteners:** All stainless steel

**Rope:** VRX 25: 50' x 3/16" (15m x 4.8mm) steel,  
VRX 25-S: 50' x 3/16" (15m x 4.8mm) synthetic

**Hook:** Zinc plated

**Fairlead:** VRX 25: Roller, VRX 25-S: Cast aluminum hawse

**Primary Control:** Handlebar-mounted rocker switch

**Remote Control:** Sold Separately

**Brake:** Mechanical brake

**Mechanical Warranty:** Limited lifetime

**Electrical Warranty:** 3 year

Line Pull Lbs. (Kg)	Line Speed Ft./min. (M/min.)	Motor Current	Pull by layer: layer/Lbs. (kg)
0	17.5 (5.3)	20 amps	1/2500 (1134)
500 (227)	14.3 (4.3)	45 amps	2/2141 (971)
1000 (454)	12.0 (3.6)	71 amps	3/1872 (849)
1500 (680)	9.9 (3.0)	98 amps	4/1663 (754)
2000 (907)	8.0 (2.4)	128 amps	5/1496 (679)
2500 (1134)	6.8 (2.1)	159 amps	

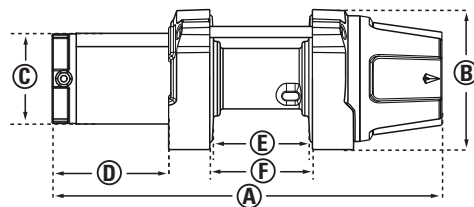

<b>A</b> 13.2" (335.3mm)	<b>D</b> 3.94" (100.2mm)
<b>B</b> 4.74" (120.5mm)	<b>E</b> 3.30" (83.9mm)
<b>C</b> 3.07" (78 mm)	<b>F</b> 3.5" (88.9mm)

Mounting bolt pattern: 3.0" x 4.87" (76mm x 124mm)

**WARN INDUSTRIES, INC.**

12900 S.E. Capps Road, Clackamas, OR USA 97015-8903 [warn.com](http://warn.com)

Customer Service (North America): 1-800-543-9276 International Sales Support: +1 503 722 1200

