

kovil®

Kovil Oy
Taitajantie 2
FIN-57210 Savonlinna
Finland
Tel. +358-(0)15-578 40
Fax +358-(0)15-578 421

INSTALLATION INSTRUCTIONS

Vehicle information:

Make (manufacturer): **Mercedes Benz**
Model(s): **E-Class Estate**
2010-
Type(s): **S212**

Towbar information:

Product No (Version): **35627L**
EC type: **KL030**
EC approval No: **e11*94/20*7637*00**
Vertical mass on coupling S: **max. 84 kg** (See vehicle data)
D -value D: **max. 11.20 kN**
Weight of towbar: **24 kg**

D -value equals e.g. C = 2100 kg and T = 2500 kg.

Follow also vehicle specified restrictions (see registration document and other data of vehicle).

D -value of towbar must not be exceeded.

D= D -value [kN]

T= Maximum mass of vehicle [kg]

C= Maximum mass of centre axle trailer -
Vertical mass (S) on coupling [kg]

$$D = T \times C \times 9.81 / ((T + C) \times 1000)$$

$$T = C \times D \times 1000 / ((C \times 9.81) - (1000 \times D))$$

$$C = T \times D \times 1000 / ((T \times 9.81) - (1000 \times D))$$

General instructions:

READ INSTALLATION INSTRUCTIONS BEFORE INSTALLING THE TOWBAR!

- Remove underseal or other thick coating on contact area between bodywork and towbar. Treat bare sections (and drilled holes) with thin anti-corrosive coating.
- Clean threads of welded nuts and screws before assembly.
- Installation instructions and other operating and maintenance instructions, if enclosed, shall be kept with vehicle documents.
- Coupling ball must be kept clean and greased.

Notice!

- Constructional changes to towbar or to its assembly are forbidden. Defective towbar must be replaced with a new one together with complete assembly set.
- Smallest diameter of coupling ball must not be less than 49 mm to any direction.
- **Manufacturer's responsibility shall not concern any damage caused by incorrect installation or use of towbar.**

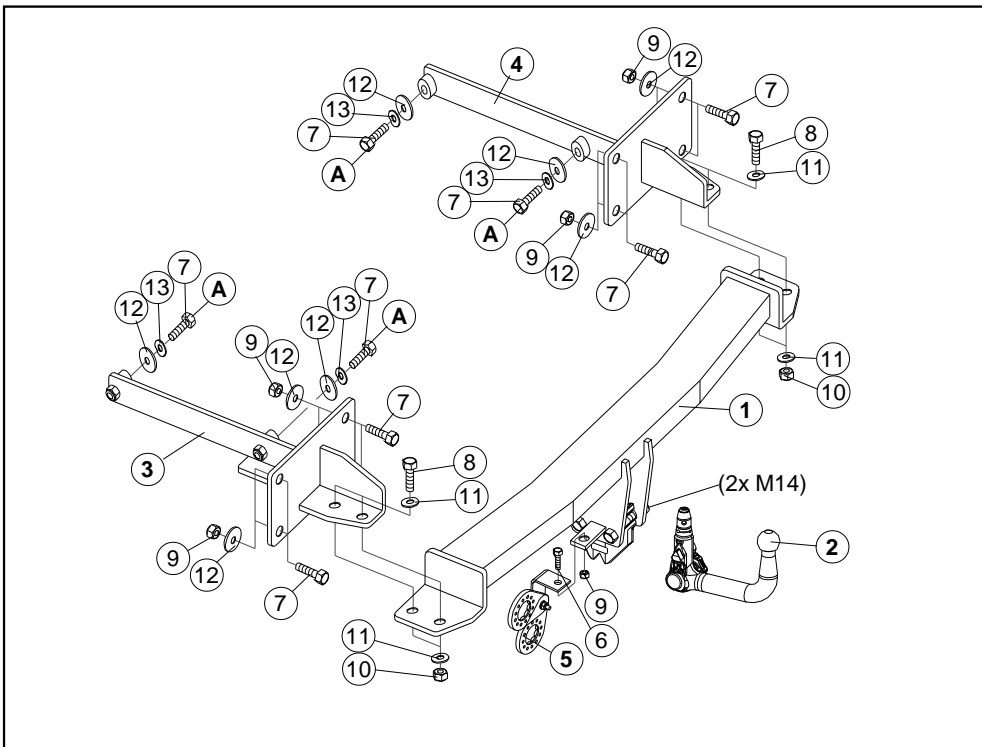

Installation set:

Pos	Qty	Part
11	Cross beam
21	Ball part (AL-KO 3KS2-K5)
31	Side part left
41	Side part right
51	Socket holder (#77100)
61	Screw M10 x 25
712	Screw M10 x 40
84	Screw M12 x 40
99	Lock nut M10
104	Lock nut M12
118	Washer 13 x 24
1212	Washer 11 x 33
134	Spring washer M10

Tightening torque:

M6 - 8.8 10 Nm
M8 - 8.8 30 Nm
M10 - 8.8 47 Nm
M12 - 8.8 90 Nm
M14 - 8.8 130 Nm
M16 - 8.8 195 Nm
M10 x 1,25 - 8.8	... 40 Nm
M12 x 1,25 - 8.8	... 70 Nm
M12 x 1,5 - 8.8 80 Nm
M14 x 1,5 - 8.8	... 135 Nm

Appendices:

- 1 Mounting manual (3KS)

Notice! Unpack the installation set and check before assembly that all parts are included.
For removing parts from vehicle see detailed instructions in workshop manual!

Hint: Follow installation instructions for electric wiring kit and install wires while mounting the towbar.

- Release from trunk room side boxes, package fasteners, bottom plate and bottom plate supports on left and right. Demount also spare wheel and upholstery on spare wheel casing floor.
Demount tail lights.
Demount rear bumper and possible wiring.
Demount heat protection plate beside silencer and rearmost silencer support.
Demount collision beam from rear panel (will not be re-mounted).
- Cut openings in packings in rear panel for side parts left (3) and right (4) and remove rubber plugs from fixing points **A** in trunk room.
Insert side parts (3) and (4) into vehicle side frames and mount loosely from trunk room side in holes **A** with washers (12), spring washers (13) and screws (7).
Mount side parts (3) and (4) in holes in rear panel with screws (7), washers (12) and nuts (9).
- Mount towbar cross beam (1) to side parts (3) and (4) with screws (8), washers (11) and nuts (10).
- Align parts and tighten all screws / nuts carefully to the right torque, see table.
Tighten first nuts facing rear panel.
- Tighten seams between towbar and rear panel (with eg. underseal).
- Mount silencer support, heat protection plate and rear bumper back to vehicle.
- Mount socket holder (5) to towbar cross beam (1) with screw (6) and nut (9).
(Mount electric wiring kit, check operation of turnable socket holder with socket.)
- Re-mount other demounted parts back to vehicle.
- Ball part (2) will be installed and maintained according to enclosed manual. Follow the instructions frequently.

NOTE! Crossbeam prevents use of original towing bracket on rear side, towbar can be used for towing according to road traffic act.