

Montage-handleiding elektrokabelset voor  
trekhaak met 13-P contactdoos  
vlgs. DIN/ISO norm 11446

Fitting instructions electric wiringkit  
towbar with 13-P socket up to  
DIN/ISO norm 11446

Einbauanleitung Elektrosatz  
Anhängervorrichtung mit 13-P Steckdose  
lt. DIN/ISO Norm 11446

Instructions de montage du faisceau  
électrique pour crochet d'attelage  
conforme à la norme DIN/ISO 11446  
prise 13-P

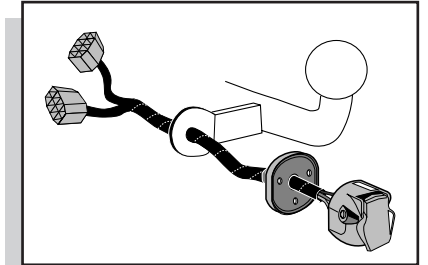

## NISSAN PRIMERA ESTATE P11 1998-

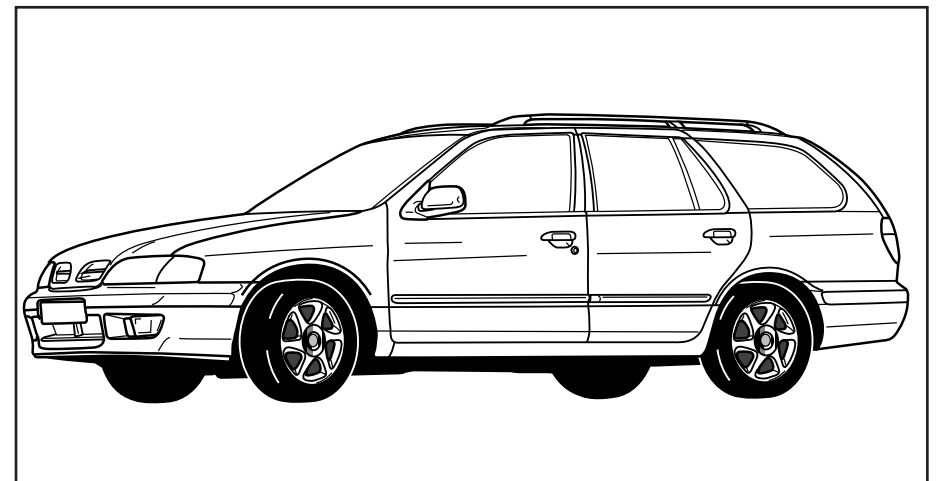

Bestel Nr.: NI-004-BB



1

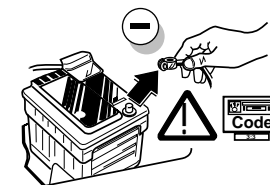
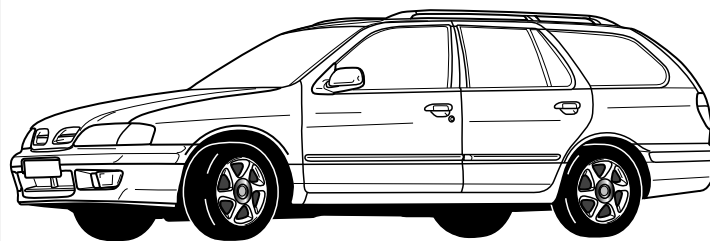

2

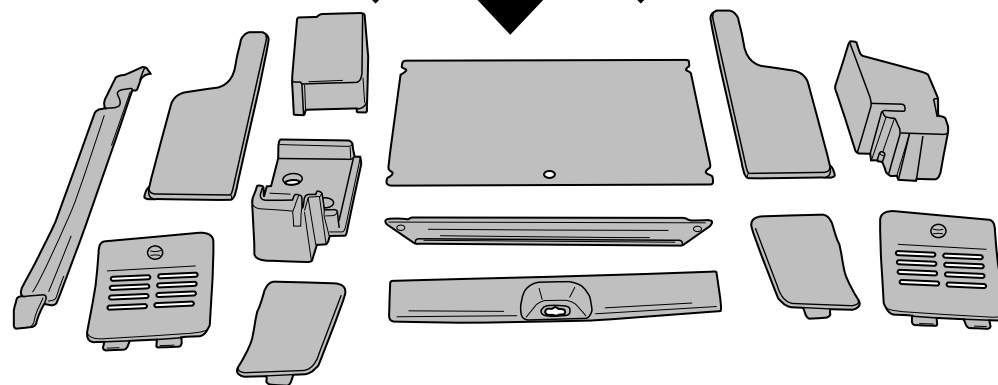
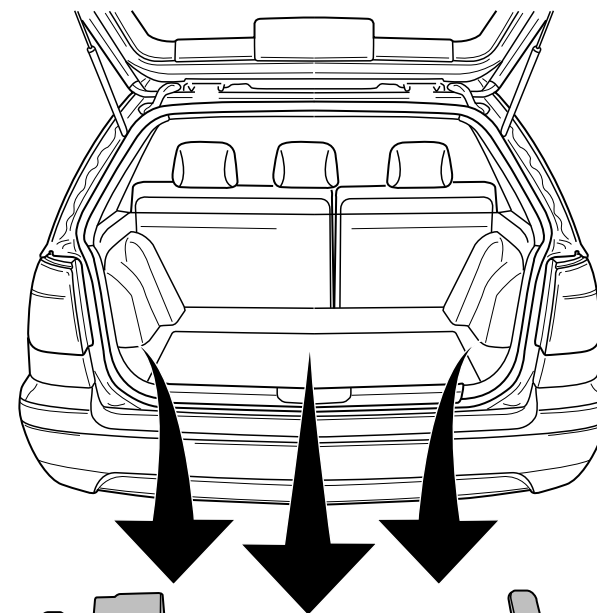

3

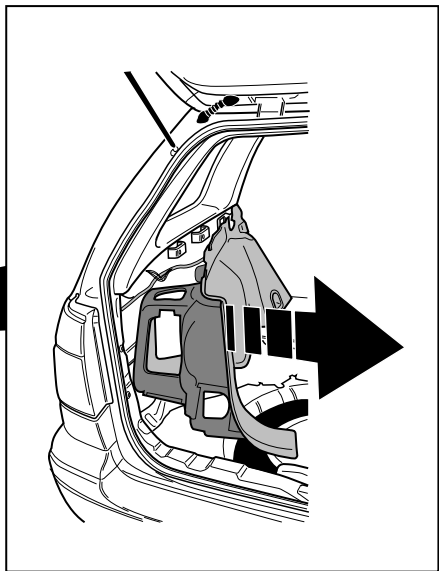
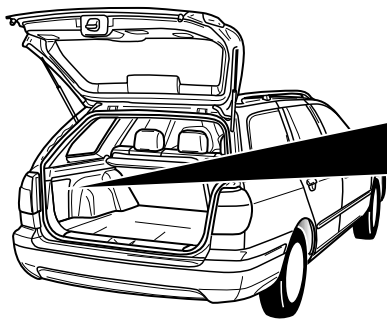

INFO

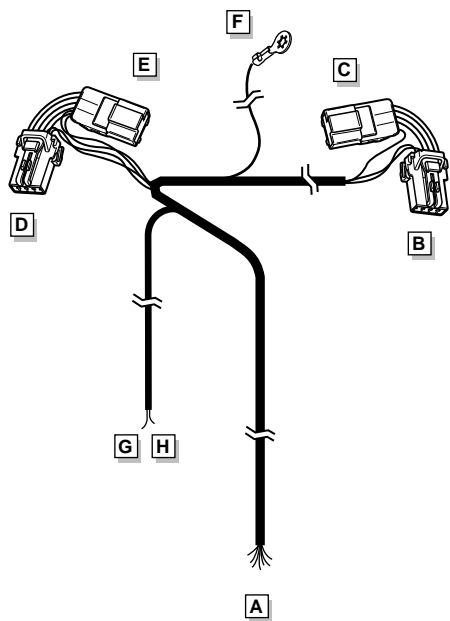

4

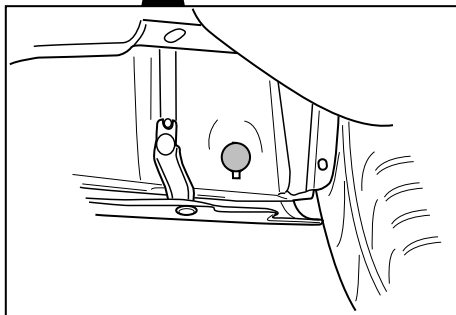
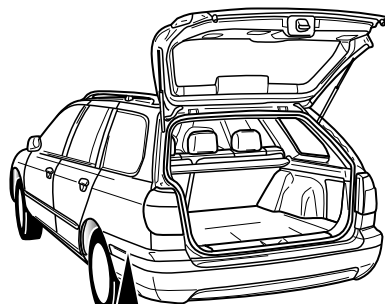

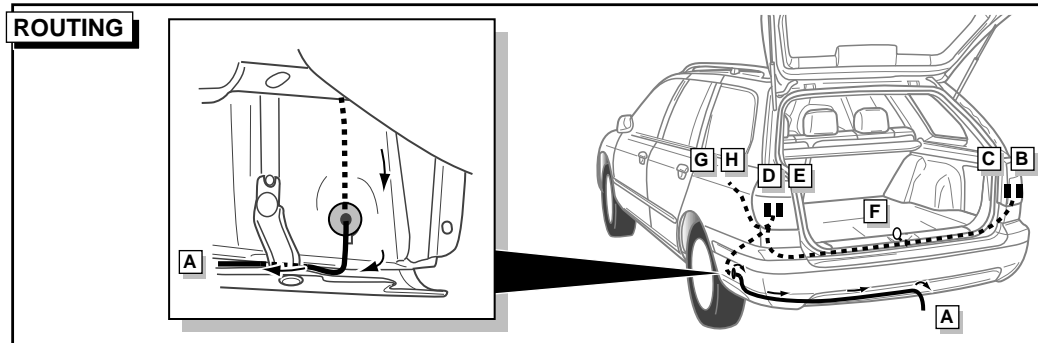
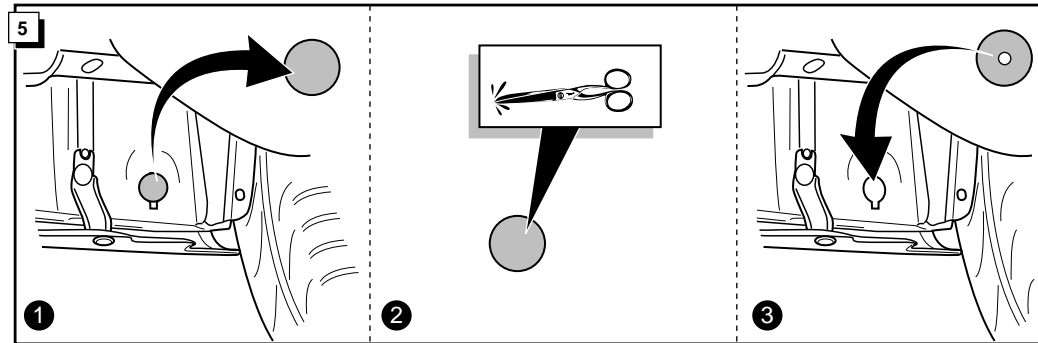
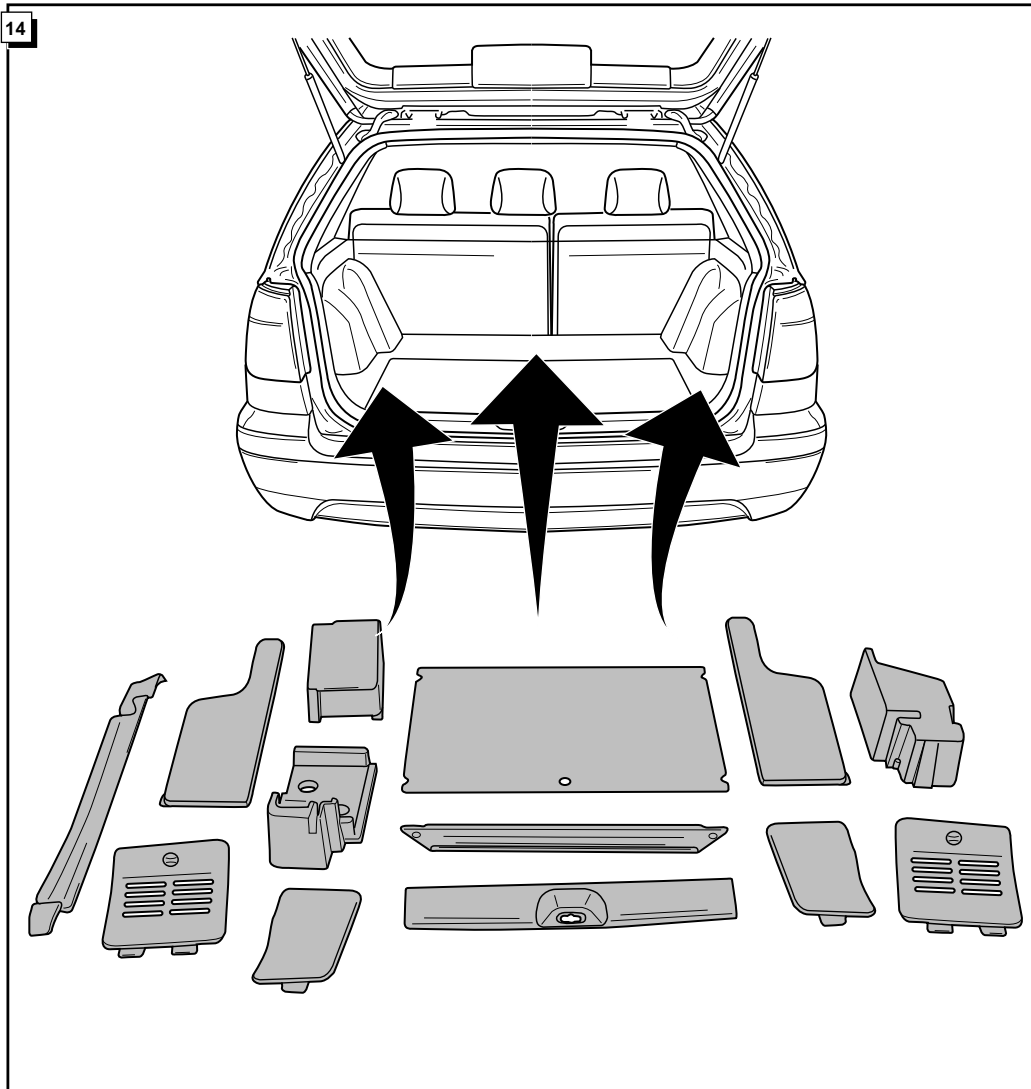
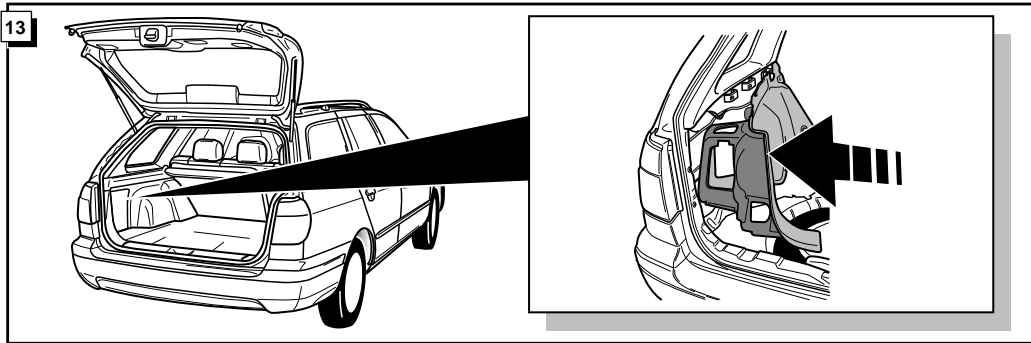

6

	(D)	(FR)	(GB)	(NL)
1 = L	GELB	JAUNE	YELLOW	GEEL
2 = 54-G	BLAU	BLEU	BLUE	BLAUW
3 = 31	WEIß	BLANC	WHITE	WIT
4 = R	GRÜN	VERT	GREEN	GROEN
5 = 58-R	BRAUN	MARRON	BROWN	BRUIN
6 = 54	ROT	ROUGE	RED	ROOD
7 = 58-L	SCHWARZ	NOIR	BLACK	ZWART
8 = 58-B	GRAU	GRIS	GREY	GRIJS

1

2

3

BLINKER LINKS  
CLIGNOTANT GAUCHE  
L.H. INDICATOR  
KNIPPERLICHT LINKS

BLINKER RECHTS  
CLIGNOTANT DROIT  
R.H. INDICATOR  
KNIPPERLICHT RECHTS

MASSE  
MASSE  
EARTH  
MASSA

STOP

BREMSLEUCHE  
FEUX DE STOP  
BRAKELIGHTS  
REMLICHTEN

SCHLÜBLEUCHE LINKS  
FEU ARRIERE GAUCHE  
L.H. REARLIGHT  
ACHTERLICHT LINKS

SCHLÜBLEUCHE RECHTS  
FEU ARRIERE DROIT  
R.H. REARLIGHT  
ACHTERLICHT RECHTS

